

nophADRAIN®

SMART GREEN ROOF SYSTEMS

0.3

Nophadrain Intensive Green Roof Systems

Design and installation guide for intensive
green roof systems

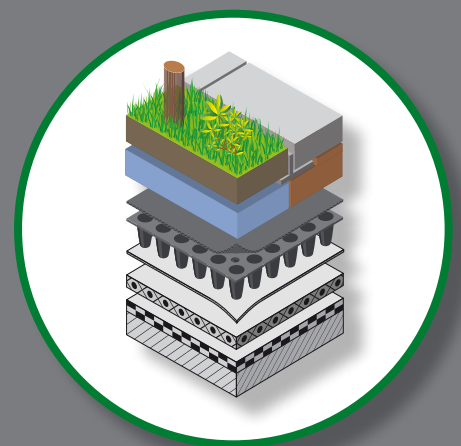
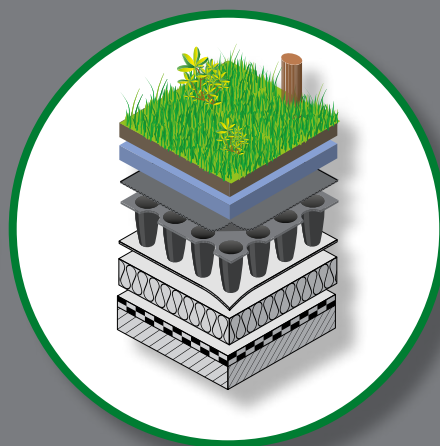
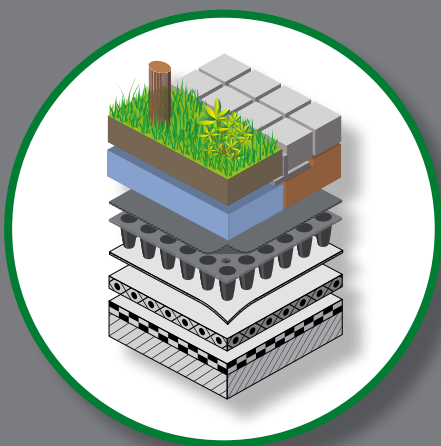



'Dakpark Vierhavenstrip - Rotterdam'

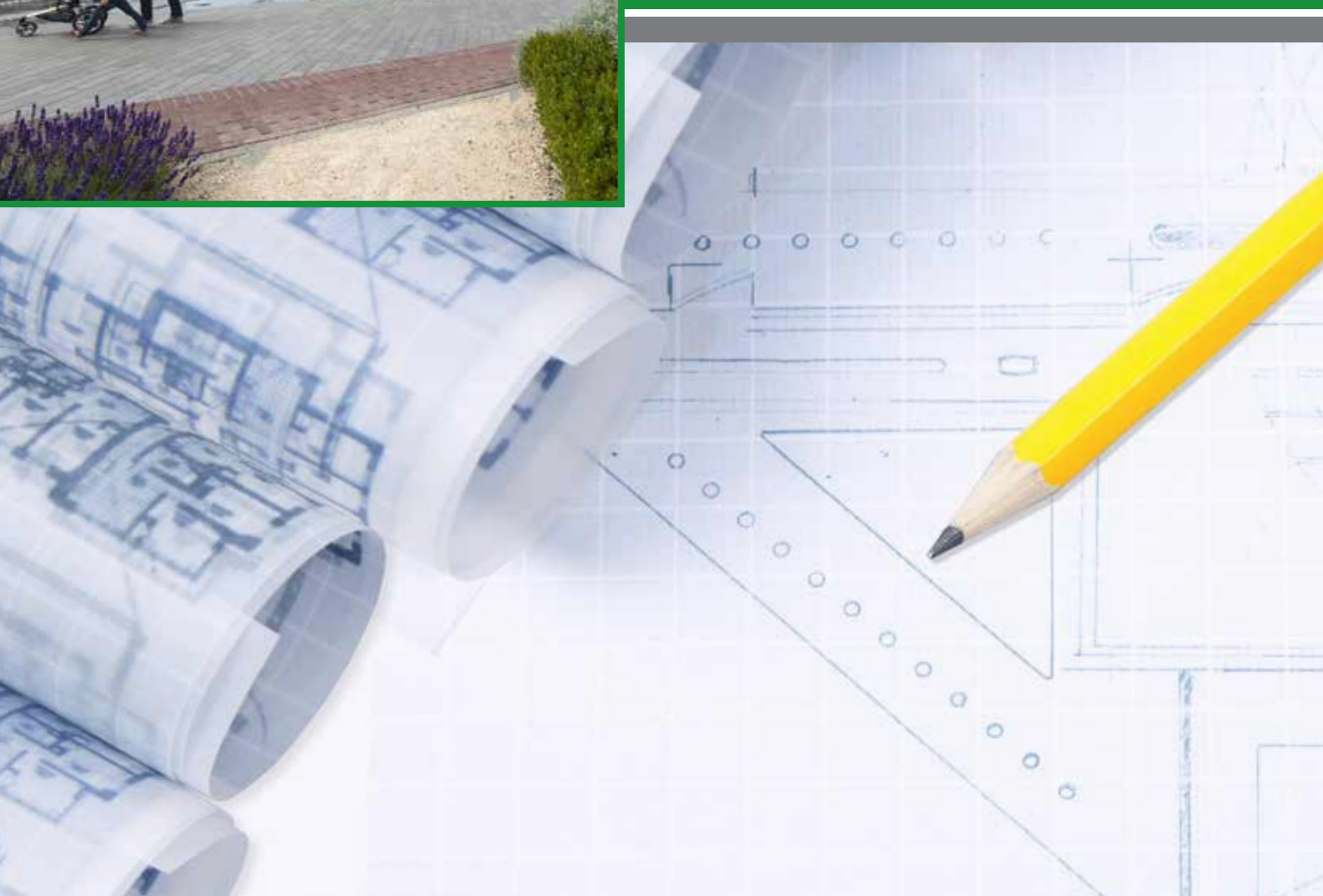

0 Introduction	
0 Introduction	1
1 Design considerations	
1.1 Standards	1
<ul style="list-style-type: none"> • CE-marking hEN 13252 • FLL-Guideline for the Planning, Construction and Maintenance of Green Roofing, published 2018 	
1.2 Design loads	1
1.3 Roof constructions	3
<ul style="list-style-type: none"> • Cold roof construction • Warm roof construction • Inverted roof construction • Roof construction without thermal insulation 	
1.4 Thermal insulation	3
1.5 Waterproofing systems	4
<ul style="list-style-type: none"> • Continuous waterproofing systems <ul style="list-style-type: none"> ◦ Bitumen - modified bitumen waterproofing membranes (APP – SBS) ◦ Synthetic waterproofing membranes ◦ Mastic asphalt ◦ Water resistant concrete 	
1.6 Details	5
<ul style="list-style-type: none"> • Roof edge • Facade • Roof protrusion with and without upstand • Roof outlet 	
1.7 Design of falls - roof slope	8
1.8 Designing for stormwater	8
<ul style="list-style-type: none"> • Roof drainage • Run-off coefficient • Annual stormwater retention capacity 	
1.9 Fall protection	9
1.10 Fire prevention	9
1.11 Wind loads	9
1.12 Protection from emissions	9
1.13 Design features	10
1.14 Protection from calcium deposits	10
1.15 Maintenance	10

2 The composition of an intensive green roof	
2.1 Composition	10
<ul style="list-style-type: none"> • Multi-layer green roof composition 	
2.2 Root barrier layer	11
2.3 Separation and slip layer	11
2.4 Protection layer	11
2.5 Drainage layer	12
2.6 Filter layer	12
2.7 ND Drainage Systems	12
<ul style="list-style-type: none"> • ND Drainage Systems on inverted roof constructions • Dimensioning ND Drainage Systems 	
2.8 Water retention layer	13
2.9 Growing medium layer	14
<ul style="list-style-type: none"> • Substrate • Topsoil • Foamed glass 	
2.10 Vegetation layer	15

3 Intensive green roofs combined with hard landscaping	
3 Intensive green roofs combined with hard landscaping	15

4 Nophadrain Intensive Green Roof System	
4.1 Roof with sufficient fall 1 in 80 to 5 °	16
<ul style="list-style-type: none"> a. Warm roof construction / roof construction without thermal insulation b. Inverted roof construction 	
4.2 Roof with insufficient fall < 1 in 80	17
<ul style="list-style-type: none"> a. Warm roof construction / roof construction without thermal insulation b. Inverted roof construction 	
Composition of an intensive green roof	

0 Introduction

Intensive greening of a roof can be considered comparable to more traditional soft-landscaping schemes in terms of potential use and diversity of design. Planting can include lawn, shrubs, bushes and even the occasional tree. Once planted, the vegetation imposes a fairly high demand on the composition layers and needs regular irrigation (or a water retention system) as well as a regular supply of plant nutrients. This type of green roof can only thrive with regular maintenance. An intensive green roof can easily be combined with hard landscaping for pedestrians and vehicular traffic.

Due to the vegetation's demands for water and nutrients, along with the planting itself, the typical minimum weight of this type of green roof would be around 282 kg/m² with a minimal layer depth of 217 mm. When designing intensive green roofs, these high loadings must be taken into consideration.

Features of an intensive green roof:

- wide choice of suitable vegetation
- total freedom of design
- easily combined with pedestrian and vehicle accessible areas
- construction height – starting from 217 mm
- dead load – starting from approx. 282 kg/m²

1 Design considerations

1.1 Standards

CE-marking hEN 13252

Geotextiles and geotextile-related products for use in drainage systems must bear a CE marking pursuant to the European Standard hEN 13252 'Geotextiles and geotextile-related products - Characteristics required for use in drainage systems'. Drainage systems are defined as systems that collect and transport precipitation, ground water and/or other liquids or gases via a geotextile or a geotextile-related product.

This European Standard covers more than just geotextiles such as filter membranes and filter fabrics. Geotextile-related products such as geocomposites (drainage channels and drainage panels) and geospacers (nubbed film and nubbed panels [so-called eggbox-shaped dimples]) are also covered by this standard (hEN ISO 10318 'Geosynthetics - Part 1: Terms and definitions').

As a manufacturer, Nophadrain BV is responsible for issuing a Declaration of Performance (DoP) relating to the essential characteristics of the geotextiles and drainage channels that it has brought onto the market pursuant to the European Standard hEN 13252). Part of the Declaration of Performance is an internal production control system that is assessed annually by a certification institute (Notified Body). The Declaration of Performance, which is to be published on the Nophadrain website, entitles Nophadrain BV to use the CE-marking on its products.

The product therefore satisfies the national provisions set by the European Member States with regard to the essential

characteristics of construction products. All geotextiles and geotextile-related products brought onto the market by Nophadrain BV bear the CE-marking.

FLL-Guideline for the Planning, Construction and Maintenance of Green Roofing, published 2018

There are no European standards which specify the design of green roofs. The FLL-(a research institute in Germany) has drawn up a guide for the design, installation and maintenance of green roofs. This guide sets out the basic principles and requirements that, in general, apply to the design, installation and maintenance of green roofs. This guide is based upon scientific research and practical experience in building green roofs in Germany over the past 20 years.

In many countries throughout Europe this document has been accepted as the key guide for building green roofs. This Nophadrain brochure is also based upon this FLL-Green Roof Guideline (2018).

* Three-dimensional polymeric structure designed to create an air space in soil and / or other materials in geotechnical and civil engineering applications (hEN ISO 10318)

1.2 Design loads

The structural deck should be able to withstand and to absorb the static and dynamic loads imposed during construction and final use.

The load on a roof is determined by the:

- dead permanent load imposed by the weight of the construction
- permanent load imposed by the composition of the green roof
- variable load due to e.g. maintenance work or traffic load

The assumed permanent load of an intensive green roof at maximum water capacity:

Vegetation	Vegetation load kg/m ²	ND DGS-I Substrate Intensive* depth mm/load kg/m ²	ND WSM-50 Water Reservoir Panel depth mm/load kg/m ²	ND Drainage System depth mm/load kg/m ²	ND WSB-80 Root Barrier** load kg/m ²	Surface load kg/m ² ***	Total depth mm***
Lawn	5	150 / 225 350 / 525	50 / 46	17 / 5.31	0.8	282 582	217 417
Low growing shrubs and bushes	10	150 / 225 500 / 750	50 / 46	17 / 5.31	0.8	287 812	217 567
Medium-sized shrubs and bushes up to 1.5 m	20	200 / 300 500 / 750	50 / 46	17 / 5.31	0.8	372 822	267 567
Large-sized shrubs and bushes up to 3 m	30	350 / 525 700 / 1,050	50 / 46	17 / 5.31	0.8	607 1,132	417 767
Large-sized bushes and small-sized trees up to 6 m	40	600 / 900 1,250 / 1,875	50 / 46	17 / 5.31	0.8	992 1,962	667 1,317
Medium and large-sized trees up to 10 m	60	1,000 / 1,500 2,000 / 3,000	50 / 46	17 / 5.31	0.8	1,612 3,112	1,067 2,067
Large-sized trees up to 15 m	150	1,500 / 2,250 2,000 / 3,000	50 / 46	17 / 5.31	0.8	2,452 3,202	1,567 2,067

Table 1. Design loads

* Weight approx 1.5 tonne/m² at maximum water capacity

** Optional for usage in a non-root resistant waterproofing membrane

*** When using ND 5+1 the total depth increases by 10 mm and the surface load with 2.5 kg/m² (ND 5+1)

There are no published standards governing the construction of elemental pavements over a roof deck in the UK or RoI. Through research in close cooperation with the Technical University in Munich, Germany, the following load classes can be distinguished based upon the intended use of the roof deck:

Load class	Use	Traffic	Axle load	Wheel load
1	Podium roof decks, patio roof deck	Pedestrian, bicycles	—	—
2	Parking roof deck	Cars	10 kN front axle 15 kN rear axle	5 kN front axle 7.5 kN rear axle
3	Parking roof deck	Heavy good vehicles (HGV)	100 kN	50 kN

Table 2. Load classification

The construction of elemental pavements over roof decks for the various load classes is described in the Nophadrain brochure "Design and Installation Guide Podium Roof Decks – Parking Roof Decks". The suitability of the Nophadrain Parking Deck Systems can

be shown by extensive and external test reports in which the total composition is subject to a dynamic performance test. These reports are available upon request.

1.3 Roof instructions

The structural deck needs to be able to carry the extra load of the intensive green roof composition. The waterproofing membrane should be root resistant and as with the thermal insulation, be able to carry the permanent load of the intensive green roof composition.

The following roof constructions are recognized:

Cold roof construction

This is a roof construction with an independent ceiling enclosing an air space between the structural deck and the ceiling. When insulation is used it should be placed below the structural deck with a ventilated airspace in between. The load bearing capacity of the structural deck is generally minimal and must correspond to the calculated weight of the intensive green roof. The cooling effect of an intensive green roof can affect the physical properties of the structure. Freezing temperatures on the underside of the structural deck may result in frost damage to the vegetation.

Warm roof construction

This is a roof construction without a ventilated airspace beneath the structural deck. When insulation is used it should be placed on top of the structural deck. It is recommended that a vapour control layer be placed on top of the structural deck underneath the thermal insulation. In general, all types of green roof systems and all forms of vegetation are suitable for use with this type of roof construction.

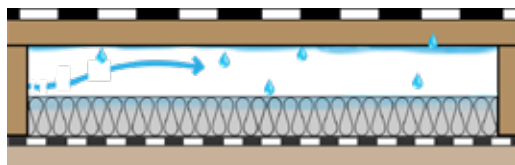

Cold roof construction

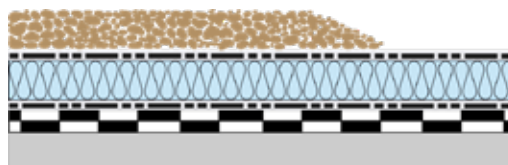

Inverted roof

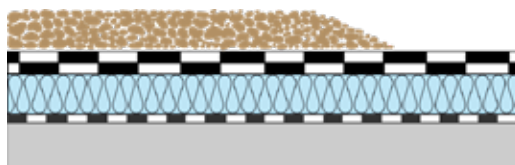

Warm roof construction

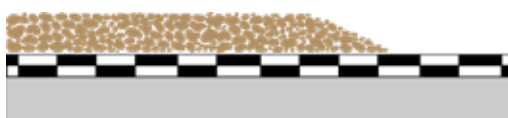

Roof construction without thermal insulation

Inverted roof construction

Insulation is placed on top of the waterproofing membrane. Should an inverted roof be selected for greening, moisture diffusion measures should be considered. When an intensive green roof is installed, a damp-permeable drainage layer must be placed over the thermal insulation in order to protect the insulation from accumulating moisture (internal condensation) over time. In general, all types of green roof systems and all forms of vegetation are suitable for use with this type of roof provided there is sufficient dead load to prevent uplift of the thermal insulation due to water and wind.

Roof construction without thermal insulation

On top of the structural deck the waterproofing membrane is installed without any thermal insulation. A characteristic of this roof construction is that the space beneath the roof is not heated. Basically all types of green roof systems and all forms of vegetation are suitable. Freezing temperatures on the underside of the structural deck may result in frost damage to the vegetation.

1.4 Thermal insulation

Thermal insulation needs to be CE-marked based upon the hEN 13162 – 13171 "Thermal insulation products for buildings. Factory made Specification".

There are two different methods for installing thermal insulation to a roof deck:

- WRC = insulation is placed beneath the waterproofing membrane – warm roof construction
- IRC = insulation placed above the waterproofing membrane – inverted roof construction

A cold roof has been omitted as this type of roof construction is rarely used nowadays.

The waterproofing membrane and the applied thermal insulation should be able to withstand short and long term loadings. Should any deformations of the thermal insulation be expected, it should be taken into account when detailing the waterproofing membrane (roof outlet, roof edge, roof protrusion, etc.). For load class 1, the roofs built on an insulated roof, the thermal insulation should meet minimum load class "dh". For load classes 2 and 3 the thermal insulation should meet load class "ds" respectively load class "dx". The suitability of thermal insulation is to be demonstrated by the manufacturer.

Suitability of the various types of thermal insulation:

Thermal insulation classification	Roof construction	dm	dh	ds	dx
Expanded polystyrene (EPS)* in accordance with hEN 13163 "Thermal insulation products for buildings. Factory made products of expanded polystyrene. Specification"	WRC	100 kPa*	150 kPa*	—	—
	IRC	—	—	—	—
Extruded polystyrene (XPS)* in accordance with hEN 13164 "Thermal insulation products for buildings. Factory made products of extruded polystyrene. Specification"	WRC	200 kPa*	300 kPa*	500 kPa*	—
	IRC	300 kPa*	300 kPa*	500 kPa*	700 kPa*
Rigid polyurethane foam (PUR)* in accordance with hEN 13165 "Thermal insulation products for buildings. Factory made products of rigid polyurethane foam. Specification"	WRC	100 kPa*	100 kPa*	150 kPa*	—
	IRC	—	—	—	—
Cellular glass (CG)* in accordance with hEN 13167 "Thermal insulation products for buildings. Factory made products of cellular glass. Specification"	WRC	400 kPa*	400 kPa*	900 kPa*	1,200 kPa*
	IRC	—	—	—	—

Load classification	Description	Possible application
dm	Medium load bearing	Extensive green roof
dh	High load bearing	Intensive green roof/podium roof deck
ds	Very high load bearing	Parking deck with limited car traffic
dx	Extreme load bearing	Parking deck with car and truck traffic

Table 2. Load classification thermal insulation

Recommendation

If a paving needs to be installed on top of an insulated roof, it is recommended that an inverted roof construction with XPS insulation or a warm roof construction with cellular glass will be chosen. With an inverted roof the waterproofing membrane should be fully bonded with the structural deck, in order that any leak in the waterproofing membrane can be located easily. The XPS insulation panels offer extra protection of the waterproofing membrane during installation of the paving composition.

It is important that a damp-permeable drainage layer is placed on top of the XPS insulation. This allows the panels to dry. Water absorption due to internal condensation will be minimised. It is not necessary to install a separate vapour control layer as the waterproofing itself acts as one. The drainage layer should not damage the top of the insulation panels. Full bonding of the waterproofing membrane is also possible with a warm roof construction if cellular glass is used as thermal insulation. The cellular glass panels are fully bonded with the structural deck and all joints are filled with bitumen. The waterproofing system is thereby fully bonded with the cellular glass panels.

1.5 Waterproofing systems

Continuous waterproofing systems

Roof constructions are, in general, protected against the penetration of water by a waterproofing system (bitumen, synthetic or liquid applied).

When designing and choosing a waterproofing system, the intended use, applicable standards, regulations and standards of good practice have to be observed. Roof decks should be constructed with adequate falls.

The waterproofing membrane beneath the intensive planting schemes should be root resistant or protected against root penetration by a separate root barrier. Root resistance can be proven if the material has passed the FLL-root resistance test or is covered by British Board of Agrément (BBA) Certification for green roof applications.

The membranes can be applied in one or two layers and attached to the structural deck according to the following methods:

- loose laid and ballasted
- mechanically fixed
- fully bonded

The composition of a fully bonded waterproofing system can be as follows:

Bitumen – modified bitumen waterproofing membranes (APP – SBS)

- at least two layers
- first layer: a polyester based roofing felt fully bonded to the structural deck (pour and roll)
- top layer: a root resistant APP or SBS waterproofing membrane fully bonded (torched)

Synthetic waterproofing membranes

- at least two layers
- first layer: a polyester based roofing felt fully bonded to the structural deck (pour and roll method)
- top layer: an EPDM, ECB, POEB or TPO waterproofing membrane fully bonded to the first layer

Liquid-applied roof waterproofing

- liquid-applied roof waterproofing is regarded as a single layer system
- it should adhere to the entire surface and be applied in at least two discrete layers
- a suitable geotextile should be placed in between the layers as a reinforcement
- the manufacturer should have European Technical Approval in accordance with ETAG 005 "Liquid Applied Roof Waterproofing Kits"

Mastic asphalt

- the concrete sub-structure needs to be primed before installation
- as a sub-layer – a root resistant APP – SBS torch-on membrane;
- the asphalt layer with a minimum thickness of 25 mm should be installed on top of the sub-base
- loose laid and ballasted

Water resistant concrete

- requirements for water-resistant concrete are specified in hEN 206-1 "Concrete. Specification, performance, production and conformity" and BS 8500 "Concrete – Complementary British Standard to hEN 206-1 Parts 1 and 2"
- cracks in any direction should be limited to ≤ 0.2 mm

Recommendation

It is recommended that a waterproofing membrane is fully bonded with the structural deck. In many installations, leakages occur due to incorrect detailing, poor choice of materials, or error/damage incurred during installation. When a loose laid waterproofing system is damaged, the point of leakage is difficult to locate as the water can move freely over the structural deck. Fully bonded waterproofing systems give much more security if they are installed on a closed structural deck. This means that with insulated roof constructions the choice is limited to a warm roof with cellular glass or PUR and an inverted roof with XPS insulation

If it has been decided to install a warm roof construction in which the waterproofing membrane is not fully bonded with the structural deck, it is recommended that separate compartments within the vapour control layer be created. In case of any damage to the waterproofing membrane, any leak can be located more easily.

1.6 Details

Basically, the same waterproofing detail principles apply to green roofs as to flat roofs. The waterproofing membrane should be brought up above the surface level by at least 150 mm at roof upstand details e.g. parapets, abutments, and roof protrusions.

Roof edge

At roof edge details a clear strip of clean gravel (min. 16/32 mm) or concrete slabs should be installed for maintenance and inspection purposes. The minimum recommended width is 300 mm. To prevent the growing medium being washed into the clear strip, a ND GARDLINER® Edge Retaining Profile should be installed.

If the waterproofing membrane projects over the roof edge into the ground, it is recommended that the waterproofing membrane extends a minimum 500 mm beyond the edge and at least 200 mm over a joint.

ND products:

ND GARDLINER® FSD Fixing Anchor Roof
ND GARDLINER® 100/4V Edge Retaining Profile
ND GARDLINER® 150/4V Edge Retaining Profile
ND GARDLINER® 200/4V Edge Retaining Profile

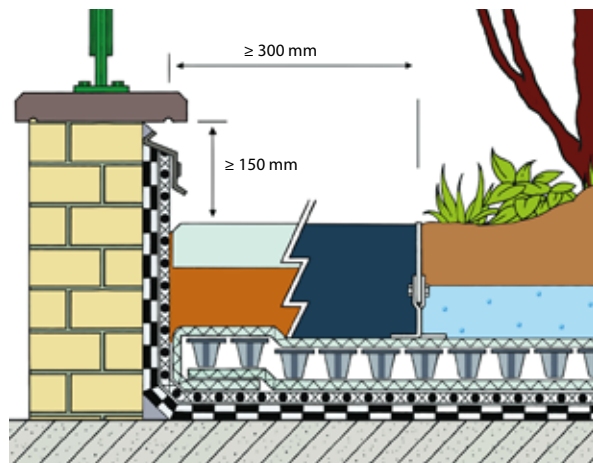
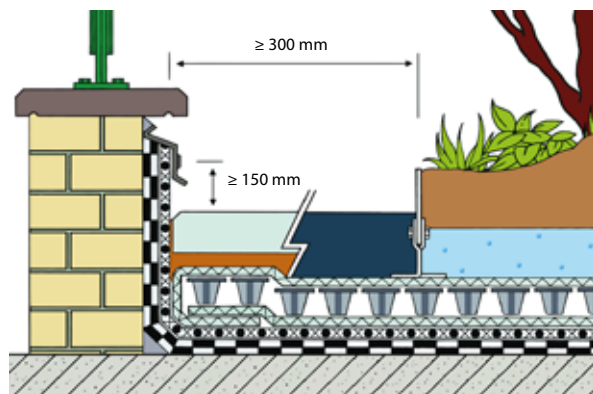

Detail 1. Parapet

Facade

At facades, the waterproofing membrane should be brought up above the highest roof edge by a minimum of a 150 mm above service level. This is not always possible at door thresholds, therefore at those door thresholds where a channel drain is installed, the waterproofing membrane can be brought up above the surface level by 50 mm.

Along facades, a clear strip of clean gravel (min. 16/32 mm) or concrete slabs should be installed for maintenance and inspection purposes, and to act as a splashguard. The clear strip between the facade and the vegetated area helps to prevent any water run-off adversely affecting the development of the plants. To prevent the growing medium being washed into the clear strip, a ND GARDLINER® Edge Retaining Profile should be installed. The minimum recommended width of this clear strip is 300 mm.

ND products:

ND GARDLINER® FSD Fixing Anchor Roof
ND GARDLINER® 100/4V Edge Retaining Profile
ND GARDLINER® 150/4V Edge Retaining Profile
ND GARDLINER® 200/4V Edge Retaining Profile

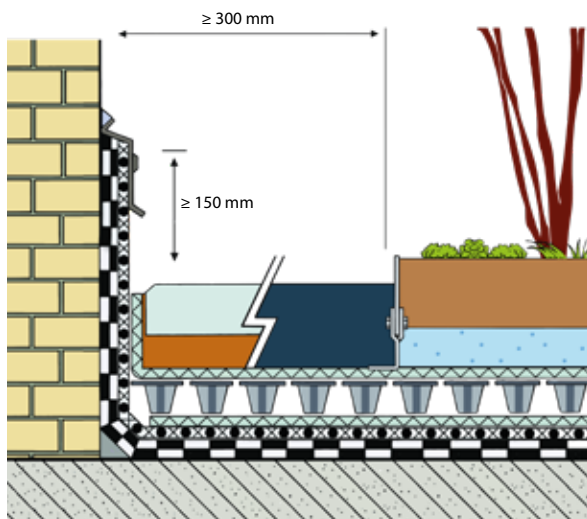

Detail 2. Facade

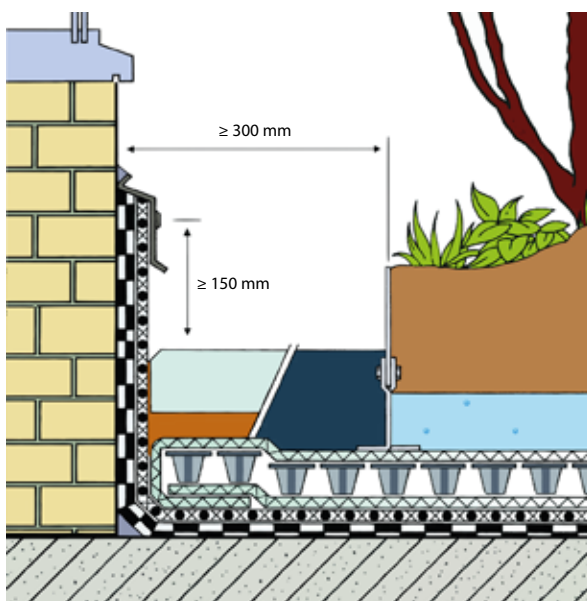
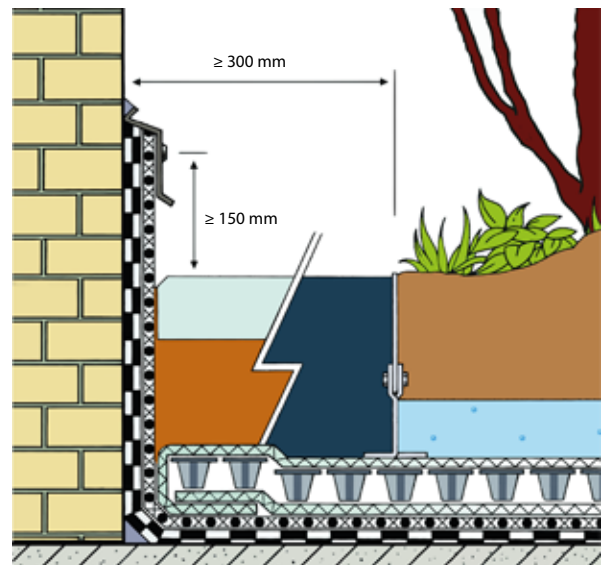

Detail 3. Facade with opening

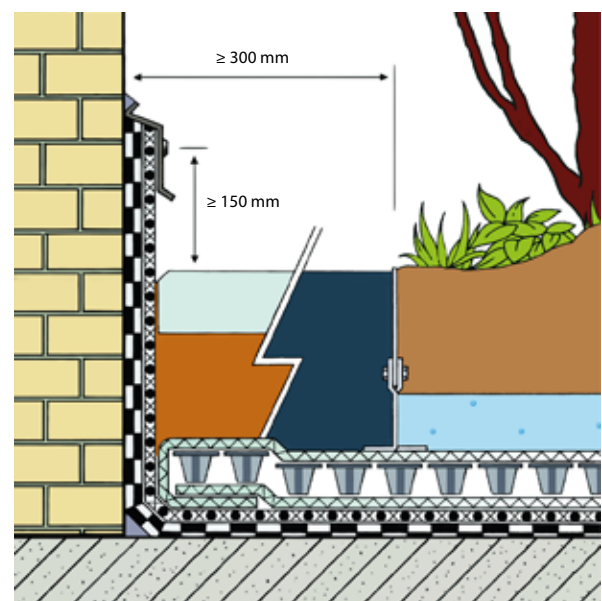

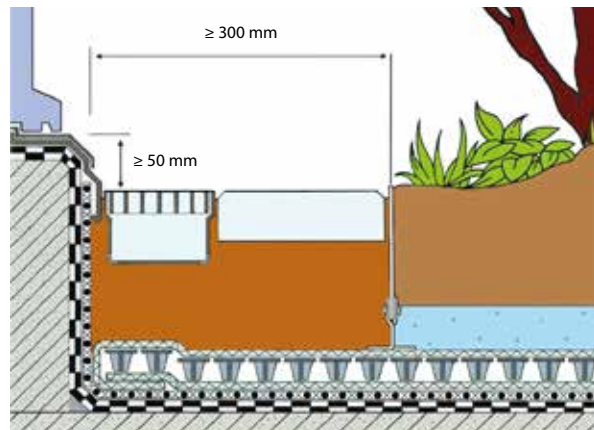
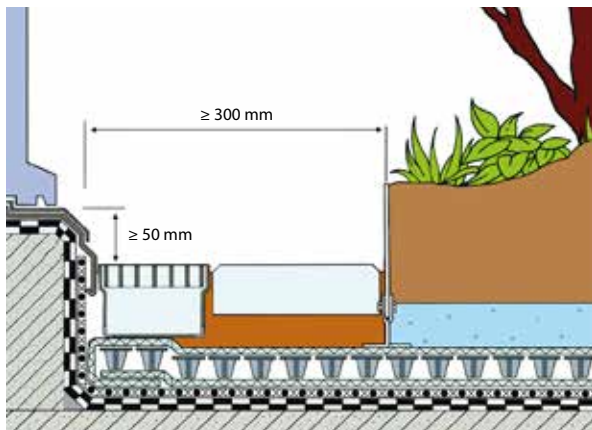

Detail 4. Door threshold

Roof protrusion with or without roof upstand

The roof upstand of e.g. roof lights, ventilation shafts and other roof protrusions must be at least 50 mm higher than the roof edge or the emergency overflow. The waterproofing membrane must be brought up to a minimum of 150 mm above service level.

Around roof protrusions with or without a roof upstand, a clear strip of clean gravel or concrete slabs should be installed for maintenance and inspection purposes. To prevent the growing medium being washed into the clear strip, a ND GARDLINER® Edge Retaining Profile should be installed. The minimum recommended width of this clear strip is 300 mm.

ND products:

ND GARDLINER® Fixing Anchor
ND GARDLINER® 100/4V Edge Retaining Profile
ND GARDLINER® 150/4V Edge Retaining Profile
ND GARDLINER® 200/4V Edge Retaining Profile

Roof outlets lying outside the vegetation area are normally positioned within a gravelled area, with a gravel guard covering the outlet. When a roof outlet is located within a hard-landscaped area, an inspection chamber fitted with a suitable grating should be placed over the outlet.

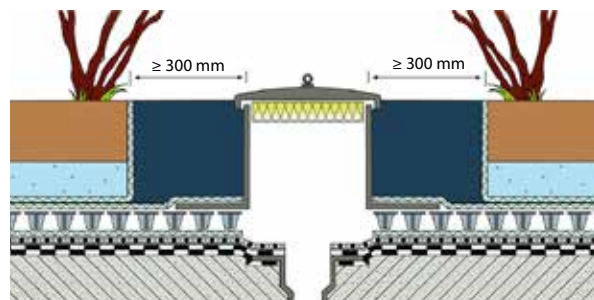

Detail 5. Roof outlet

Roof outlet

Where a roof outlet is positioned within a vegetated area, an inspection chamber complete with access cover is placed over the outlet to protect it from plant growth and impurities. The inspection chamber should not affect or impede drainage efficiency and must be accessible at all times.

A clear strip of clean gravel (min. 16 - 32 mm) should be placed around the inspection chamber. The recommended width of this clear strip should be a minimum of 300 mm. To prevent the growing medium being washed into the clear strip, a GARDLINER® ND Edge Retaining Profile should be installed.

ND products:

ND RS-8 Inspection Chamber
ND RS8-V10 Extension Element
ND RS8-V20 Extension Element
ND RS-8-R Grid Lid
ND RS-30 Inspection Chamber
ND RS-50 Inspection Chamber

Width of clear strips (vegetation-free zones):

Detail	Clear strip e.g.: gravel (minimum 16/32) / concrete slabs	Recommended width
Roof outlet	Yes	≥ 300 mm all around
Facade	Yes	≥ 300 mm
Roof edge	Yes	≥ 300 mm
Roof protrusion	Yes	≥ 300 mm

Table 5. Width of clear strips

1.7 Design of falls - roof slope

For an intensive green roof, falls should ensure that no water is allowed to pond on the roof construction. The construction should be such that any accumulated water or ponding is prevented from coming into direct contact with the growing medium layer at any time.

In order to achieve this, flat roofs should be constructed to a minimum fall of 1 in 80 (~1.3 %). This means that the design fall should be greater to take in to account deflections and inaccuracies in construction. Some designers take a fall of 1 in 80 (~1.3 %) and add an arbitrary adjustment for construction inaccuracies of 25 mm for concrete roofs and 15 mm for metal decks.

It should be noted that water might pond on the roof covering even though the roof was designed with sufficient falls. This may be due to overlaps of the waterproofing membrane, or unexpected inaccuracies in construction, or deflection of the roof construction. Consequently, where the growing medium has direct contact with standing water, the growing medium will become saturated due to capillary action. A healthy growing environment for the plants cannot be guaranteed

in such circumstances. By using ND 5+1 Drainage Systems with a construction height of 27 mm, direct contact of standing water and the growing medium can be avoided.

Roofs with a fall ratio of 1 in 20 or more ($\geq 5\%$) should have an increased water retention capacity as such relatively steep falls can result in accelerated and / or excessive water removal from the growing medium. This is achieved by increasing the depth of the growing medium layer.

ND products:

ND 4+1h Drainage System
ND 200 Drainage System
ND 220 Drainage System
ND 5+1 Drainage System
ND 800 Drainage System

1.8 Designing for the stormwater

Roof drainage

hEN 12056-3 "Gravity Drainage Systems inside buildings. Roof drainage, layout and calculation" provides for a run-off coefficient to allow for absorbent roofing surfaces where national and local regulations, and practice, permit. However, at present in the United Kingdom, no guidance is available, and so the designer is forced to adopt alternative methods if the run-off reduction effect of a green roof is to be taken into account.

For roofs with a fall of 1 in 40 (2.5 %) or flatter (nominally flat roofs) the designer should use a hEN 12056-3 Category 1 storm event for design purposes. This storm event will occur on average once per year in the United Kingdom, and will generate rainfall intensities which vary from 0.01 l/(s.m²) to 0.022 l/(s.m²) depending on geographical location. This is very short duration thunderstorm rain, and will occur on average for 2 minutes, usually in summer, when a green roof composition could be expected to be at its driest.

In using this method, it is assumed that any storm greater than this intensity would be absorbed into the green roof composition, or would pond on any hard surfacing between green areas. The roof deck should however be strong enough to resist the loads imposed by minor ponding, as it should have been designed to cope with the loadings from the green roof.

For roof falls greater than 1 in 40 (2.5 %), a hEN 12056-3 Category 2 or 3 storm event should be used, as there is a risk of structurally significant ponding in the event of the green roof area not be capable of absorbing all the stormwater. Category 2 and 3 storm events are based on the building life multiplied by a factor of safety of 1.5 or 4.5, and results in much higher rainfall intensities (0.029 l/(s.m²) to 0.088 l/(s.m²)).

For further guidance on rainfall intensity in the United Kingdom see National Annex NB of BS EN 12056-3.

Run-off coefficients

For intensive green roofs, the following water run-off coefficients (C) can be used. The values depend on the depth of the growing medium and the roof slope:

Growing medium layer depth in mm	Roof slope $\leq 5^\circ$ (~8.8 %)	Roof slope $> 5^\circ$ (~8.8 %)
150 - 250	C = 0.3	—
250 - 500	C = 0.2	—
> 500	C = 0.1	—

Tabel 6. Run-off coefficient

Guide figures for Category 1, 2 and 3 storm event:

Area	Rainfall intensity l/(s.m ²) category 1	Rainfall intensity l/(s.m ²) category 2	Rainfall intensity l/(s.m ²) category 3
England	0.022	0.066	0.088
Scotland, Wales, and Northern Ireland	0.016	0.053	0.065
Northern Scotland, Shetlands and Orkneys	0.010	0.029	0.034

Table 7. Category 1, 2 and 3 storm event

Annual stormwater retention capacity

The annual average percentage of stormwater actually retained by a green roof is calculated as the difference between the amount of rainfall and the amount of water discharged. The inverse of this is the annual run-off coefficient, Ca. The annual stormwater retention depends more on the depth of the growing medium layer than on the type of composition and composition of the layers.

The annual average percentage of stormwater retention and the run-off coefficient of a green roof system at various construction heights, assuming an annual precipitation rate of 650 - 800 mm:

Construction height mm	Type of vegetation	Annual average stormwater retention %	Annual run-off coefficient Ca
150 - 250	Lawn, shrubs, small sized bushes	60	0.40
250 - 500	Lawn, shrubs, bushes	70	0.30
> 500	Lawn, shrubs, bushes, trees	> 90	≤ 0.10

Table 8. Annual average stormwater retention capacity

At a higher (> 800 mm) or lower (< 650 mm) annual precipitation rate the annual average stormwater retention will be lower or higher as stated in table 8.

1.9 Fall protection

On flat roofs, all necessary safety measures required for use of the roof by the public, carrying out inspection and maintenance work should be considered at the planning stage. Planning for adequate safety precautions at the design stage eliminates potentially higher costs that may be incurred should fall protection safety measures need to be installed at a later date.

Collective preventive measures, e.g. guard-rails, toe-boards, barriers, etc., should be installed. Personal fall protection equipment is not suitable for an intensive green roof as this type of green roof is designed to be accessible to the public.

1.10 Fire prevention

Properly maintained intensive green roofs are classified as "hard roofs" and as such, are regarded as resistant to flying sparks and radiating heat.

1.11 Wind loads

Waterproofing membranes and green roof layers have to be designed to take into account wind loads. It is the engineer's responsibility to determine the appropriate dead loads and the position thereof. It should be noted that the potential for wind uplift is greatest at the roof perimeters and so protective measures, such as gravel strips or concrete slabs, may be required.

Where waterproofing membranes are laid loose without being permanently fixed to the deck structure, the green roof layers may act as a ballast. The determining factor will be the dry weight of these layers.

In addition, the following is to be taken into consideration:

- the variable height, thickness and density of the vegetation
- the load of residual moisture in the layer structure
- the load of the vegetation
- the weight of the vegetation
- The open, airy nature of the planting that reduces the wind uplift of the vegetation layer

These criteria are to be included in the design wind loads calculations.

1.12 Protection from emissions

The plants may be subjected to dehydration and frost damage due to exposure to excessive warmth, cold air and / or air currents caused by ventilation systems and air conditioning. Further, gases from chimneys

and exhaust systems can cause direct damage to the vegetation. A clear strip, the area/width depending on the effect of the emission, is to be observed.

1.13 Design features

Some design features that could be included in an intensive green roof are:

- fences
- pergolas and arbours
- lamps and lighting
- ponds, rills, fountains and other water features
- benches, seating, tables, etc.

The installation and construction of design features often require object-specific detail solutions which are determined by considering their construction, the static and dynamic loads they may impose, and their physical properties.

The structural stability, weight distribution, and anchorage must be secure at all times. Stresses on the protection and drainage layers should be prevented at all times. During the design process, surface loads and stress points as well as wind stress should be considered.

1.14 Protection from calcium deposits

Carbonates released from the protection layers (i.e. cement or concrete floor screeds, plant borders, covers or design features) may cause damage to the roof drainage system.

Note

These layers should be densely formed or treated in such a way to minimise the amount of carbonate discharge. Alternatively one could choose for different materials such as metal or plastic e.g. ND GARDLINER® Edge Retaining Profiles made out of plastic or metal.

1.15 Maintenance

It is recommended that a maintenance contract be drawn up between the owner and contractor involving a long-term care plan.

The care plan should, naturally, cover essential maintenance of the plants, but it is essential that the following points are also considered:

- functionality of the drainage system and the inspection chambers for the drainage / irrigation system
- inspection for impurities, deposits and root growth in the inspection chambers

- stability of plant borders, surface fasteners and other components to make sure they are in good condition to maintain the integrity of the green roof
- inspection of the waterproofing system on damages

2 The composition of an intensive green roof

2.1 Composition

The composition of an intensive green roof comprises the following layers that are considered in subsequent sections:

- root barrier layer
- separation and slip layer
- protection layer
- drainage layer
- filter layer
- water retention layer
- growing medium layer
- vegetation layer

The various layers need to be geared in such away that the functionality of the total composition is guaranteed. Each layer has a specific function in the green roof system composition. It is possible that one product integrates the functions of several layers or that one layer consists of more than one product e.g. the ND Drainage Systems integrate the drainage and filter layer and in certain compositions, also include the separation and protection layer.

Multi-layer green roof composition

An intensive green roof system is a multi-layered construction comprising of a number of individual layers each with its own function. Within the construction, the growing medium is separated from the drainage layer by a filter fabric. The filter fabric prevents finer particles from the growing medium entering the drainage layer. This filtration ensures that a fully functional horizontal and vertical drainage is maintained at all times.

As the growing medium layer does not function as a horizontal drainage component it can be mixed with organic-based material to improve moisture retention and nutrient supply, thereby increasing the buffering action and simultaneously improving plant growth.

Advantages of a multi-layer system:

- enhanced moisture-retention of the growing medium promotes healthy plants over the longer term
- excellent long-term horizontal and vertical drainage preventing additional dead loads on the roof structure caused by rainwater ponding
- good buffering action in the growing medium provided by the presence of both finer particles and organic material
- suitable for both flat and pitched roofs

2.2 Root barrier layer

The root barrier layer prevents the ingress of roots into the waterproofing layer. The root barrier layer can be integrated in a root resistant waterproofing membrane e.g. PVC, EPDM or bitumen-copper waterproofing membranes tested in accordance with a root resistance test.

If the waterproofing membrane is not root resistant, a separate root barrier should be placed directly on top of the waterproofing membrane. Overlaps have to be heat-welded along the lapped joints. Use of a separate root barrier on top of the waterproofing membrane is not required in those situations where the waterproofing membrane is root resistant.

Note

For the installation of a separate root barrier the same detail principles apply as for the installation of a waterproofing membrane. On inverted roof constructions lacking a root-resistant waterproofing membrane, the root barrier is positioned directly beneath the thermal insulation and on top of the waterproofing membrane.

ND products:

ND WSB-80 Root Barrier

2.3 Separation and slip layer

The separation layer separates materials that are chemically incompatible (e.g. Polyvinyl Chloride (PVC) and Polystyrene (PS)). The separation layer can also act as a part of the slip layer. The ND Drainage Systems are available with pressure dividing slip film or separating geotextile to suit individual applications.

No forces are to be passed on to the waterproofing system by the overlying installed layers. Should such forces occur as a result of the intended use, a slip layer must be installed. A slip layer consists of two smooth surfaces installed over the waterproofing system.

In the Nophadrain Green Roof Systems, the slip layer is formed by using the ND TSF-100 Slip and Protection Sheet or ND TGF-20 Separation and Slip Film and the ND Drainage Systems.

ND products:

ND Drainage Systems
ND TSF-100 Slip and Protection Sheet
ND TGF-20 Separation and Slip Film

2.4 Protection layer

The protection layer guards the waterproofing membrane against mechanical and dynamic loadings. When using a separate protection layer, this should be a protective membrane, a rubber mat with a thickness of 4 or 6mm), or a geotextile with a minimum weight of 300 g/m², a minimum thickness of 2 mm and a puncture resistance of 1.5 kN. The protection layer should be designed to suit the conditions to which the waterproofing membrane will be subjected. The protection layer can also fulfill the function of the separation layer and form part of the slip layer.

If ND Drainage Systems are fitted immediately after installation of the waterproofing membrane, they can act as a separation and protection layer for lightweight static loads such as an intensive green roof. At heavier loadings, heavy geotextiles, plastic sheets, concrete layers, and the like are needed to guard the waterproofing membrane against damage from static and dynamic loads occurring during installation and when in use.

Recommendation

On roofs of load class 1. (podium roof decks), load class 2. and load class 3. (trafficked roof decks) where a levelling layer or sub-base is installed, or when wheeled loaders are used during installation of the growing medium on a green roof, it is recommended to install a ND TSF-100 Slip and Protection Sheet above the waterproofing system. The ND TSF-100 Slip and Protection Sheet should be installed in such a way that no granular material can get underneath and damage the waterproofing membrane.

ND products:

ND Drainage Systems
ND TSF-100 Slip and Protection Sheet

2.5 Drainage layer

The drainage layer relieves the waterproofing membrane of hydrostatic pressure. In addition, any excess water in the growing medium layer is led away, preventing potential ponding of water in the growing medium that may damage the vegetation. The drainage layer must have a good vertical permeability combined with the ability to transport excess water horizontally away from the roof area. It must maintain full functionality for a period of

50 years, in compliance with DIN 4095 "Drainage and protection of sub-structures – design, dimensioning and installation". The drainage capacity should be specified in l/(s.m) taking into account the roof slope/pitch and the expected load pressure. Any Drainage System including eggbox-shaped dimpled plastic sheets (geospacers), that forms part of a drainage system must be CE-marked, hEN 13252.

2.6 Filter layer

It is essential that the drainage layer should be permanently protected against clogging by fine particles present in the growing medium. This is achieved by using a woven or a non-woven filter fabric to retain these fine particles. The weight of this geotextile is normally 100 - 200 g/m², depending on load, and the pore size should correspond to the minimum particle size of the growing medium. In general, the geotextile should have a puncture strength of 0.06 mm - and a pore opening size of $O_{90} < 0,2$ mm. The filter layer should allow roots to grow through into the drainage layer.

Note

The woven / non-woven filter fabrics must overlap by at least 100 mm. In situations where the filter layer (geotextile) as part of a drainage system is placed on top of an eggbox-shaped dimpled plastic sheet (geospacer) or a granular material, the geotextile as well as the geospacer must be CE-marked (hEN 13252).

2.7 ND Drainage Systems

ND Drainage Systems comprise the filter layer, the drainage layer, protection layer (lightweight static loads) and the separation and slip layer as one integrated unit. The Construction height of the ND Drainage System is 13 mm / 17 mm / 27 mm. A filter fabric (woven or non-woven) is bonded to each dimple. Depending on the application, the core may be perforated and provided with a plastic film or a geotextile on the back. The dimples of the ND 4+1h / ND 5+1 Drainage System act as an additional water reservoir for the vegetation.

ND Drainage Systems on inverted roof constructions

The ND 4+1h / ND 5+1 / ND 600sv Drainage Systems have a perforated core. These Drainage Systems prevent the formation of a vapour control layer on top of the XPS thermal insulation. The top of the XPS insulation panels can dry out and therefore internal condensation is minimised. The insulation value over time is not affected.

Type ND Drainage System	ND 4+1h	ND 5+1	ND 200	ND 800
Intensive green roof – falls ≥ 1 in 80				
Intensive green roof – falls ≥ 1 in 80 (inverted roof)			–	–
Intensive green roof – falls < 1 in 80	–		–	
Intensive green roof – falls < 1 in 80 (inverted roof – exception)	–		–	–

Table 9. Applications ND Drainage Systems

Dimensioning ND Drainage Systems

The amount of water that needs to be discharged by the drainage layer (q') can be calculated per l/(s.m) by using the following equation:

q' = required amount of water to be discharged by the drainage

$$q' = \frac{A \times C_s \times r}{L_r} \text{ in l/(s.m)}$$

layer l/(s.m)

A = effective roof area m² ($L_r \times B_r$)

C_s = run-off coefficient (see table 6)

r = rainfall intensity l/(s.m²)

L_r = length of the roof to be drained m

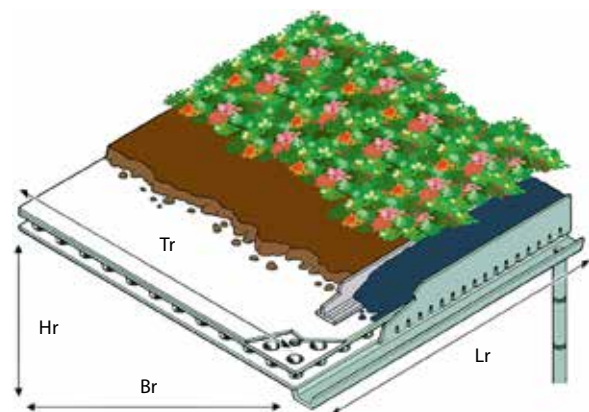

Figure 1. Roof dimensions

L_r = the length of roof to be drained

B_r = the plan width of roof from gutter to ridge

H_r = the height of roof from gutter to ridge

T_r = the distance from gutter to ridge measured along the roof

2.8 Water reservoir layer

Intensive green roof planting generally has a large surface area that results in high levels of transpiration and there is, therefore, a high demand for water. A system of irrigation-on-demand is unlikely to be successful, because, by the time the need for water has been recognized (i.e. by the wilting of the plants), damage has already occurred. Water retained by the mineral and organic content of the growing medium is only partly accessible to the plants. In order to meet the plants' need for water, the depth of the growing medium layer needs to be increased, which thereby increases the loading on the deck structure.

An alternative strategy is to provide irrigation of the growing medium through moisture diffusion by the evaporation of stored water on the structural deck, or through the evaporation of water stored in plastic Drainage Systems (e.g. in the eggbox-shaped dimpled sheets). The disadvantage of relying on moisture diffusion is that the stored water is not in direct contact with the growing medium, and consequently water is not available on demand for the planting by means of capillary action.

By installing ND WSM-50 Water Reservoir Panels, up to 40 litres of water per square metre can be retained naturally, similar to the manner in which clay or sub-soils retain water. Water is transported by direct contact of the water reservoir panels with the growing medium. The growing medium itself will not become oversaturated because the retained water is restricted to the lower 40 mm of the 50 mm thick water reservoir panels and is only transported to the upper area by capillary action when needed.

Through direct contact of the water reservoir panels with the growing medium, the vegetation is able to regulate its own water balance, as nature intended. When the water reservoir panels become saturated, surplus water is discharged into the drainage layer. By using the ND WSM-50 Water Reservoir Panels there is no composition of hydrostatic pressure against the waterproofing membrane.

The ND WSM-50 Water Reservoir Panels are manufactured from hydrophilic mineral wool. Long-term stability is achieved due to the high density (120 kg/m³). The panels have a water retention capacity of 40 l/m² at a construction height of only 50 mm. Due to the limited amount of compressibility, the panels have been approved as a substrate substitute by the FLL-Green Roof Guideline (2018)

ND products:

ND WSM-50 Water Reservoir Panels

2.9 Growing medium layer

The composition of the growing medium is important for the health and growth of the plants. It needs to be capable of retaining water, making sufficient quantities of water accessible to the plants whilst allowing any water surplus to be discharged to the drainage layer.

Substrate

The growing medium consisting of granular material contains a very low proportion of organic material (≤ 90 g/l). The FLL-Green Roof Guideline (2018) has defined the exact requirements of such a substrate. The organic content improves moisture retention and nutrient supply, thereby increasing the buffering action and simultaneously improving plant growth. The high mineral content prevents clogging of the drainage and the filter layer by small fine particles.

The depth of the substrate varies between 150 mm and 2,000 mm, depending on the type of vegetation selected. When the substrate a depth of approx. 350 mm, it will be necessary to reduce the organic matter content. At depths greater than 500 mm, a pure, mineral-based substrate should be installed beneath the intensive substrate layer. Because the substrate has little water retaining capacity due to the high mineral content, ND WSM-50 Water Reservoir Panels should be installed.

Topsoil

Even though topsoil is a much better growing medium for intensive planting schemes than a manufactured substrate, it is not often used because the high organic content causes reduced filter stability. Over time, small organic fines will clog the drainage layer and the filter layer. Research by Nophadrain shows that the use of topsoil in combination with the ND WSM-50 Water Reservoir Panels is possible. However,

it is important that a soil analysis is undertaken to determine the suitability of the available topsoil. Based upon research, soil analyses and extensive testing, Nophadrain can advise if it is possible to use a particular topsoil with the Nophadrain Intensive Green Roof Systems.

The ND WSM-50 Water Reservoir Panels not only act as a 40 l/m² water reservoir but also as an additional filter to prevent clogging of the drainage layer and filter layer.

The use of topsoil offers a considerable cost saving compared to an expensive substrate, which often has to be imported. Furthermore soil excavated on-site may be reused as a growing medium layer for an intensive green roof.

Foamed glass

Foamed glass makes it possible to create structurally stable banks and slopes on a roof with a minimum dead load. The specific weight of this material is only 150 / 350 kg/m³ (depending on the particle size and the method of compaction). The use of foamed glass offers landscape architects maximum flexibility in their designs.

ND products:

ND DGS-I Substrate Intensive
ND DGS-M Substrate Mineral
ND WSM-50 Water Reservoir Panels

The depth of the growing medium is determined by the vegetation's requirements for water, nutrients and root space:

Type of vegetation	Growing medium layer depth mm
Lawn	150 - 350
Low-growing shrubs and bushes	150 - 500
Medium-sized shrubs and bushes up to 1.5 m	200 - 500
Large-sized shrubs and bushes up to 3 m	350 - 700
Large-sized bushes and small-sized trees up to 6 m	600 - 1,250
Medium and large-sized trees up to 10 m	1,000 - 2,000
Large-sized trees up to 15 m	1,500 - 2,000

Table 10. Growing medium layer depth

Delivery

ND DGS-I Substrate Intensive / ND DGS-M Substrate Mineral:

- 1,000 litre big bags
- loose: delivered by tipper wagon - distributed by crane or conveyor system
- loose: delivered as silo load - forced air distribution

The most appropriate form of delivery is determined by the size and location of the project. There may be losses of approx. 20 % (ND DGS-I) / 15 % (ND DGS-M) due to settlement.

2.10 Vegetation layer

An intensive green roof may include one or more of the following vegetation communities:

- lawn
- low-growing shrubs and bushes
- medium-sized shrubs and bushes up to 1.5 m
- large-sized shrubs and bushes up to 3 m
- large-sized bushes and small-sized trees up to 6 m
- medium and large-sized trees up to 10 m
- large-sized trees up to 15 m
- bulbous plants

The structure and specification of the roof determine the most appropriate selection of plants. Careful planning taking in to account the structural, climatic and vegetation aspects determine the success of an intensive green roof. For more information about choosing suitable plants you can contact us by info@nophadrain.com.

3 Intensive green roofs combined with hard landscaping

Intensive green roofs can easily be combined with hard landscaping for pedestrian and vehicular traffic. The most suitable ND Drainage Systems to be used is determined by the imposed weight /loads. The ND TSF-100 Slip and Protection Sheet protects the waterproofing membrane against the imposed loads.

Flexible paving is placed on a bedding layer directly on top of the ND Drainage System. An additional sub-base should be installed beneath the bedding layer when larger loads are anticipated (e.g. trafficked areas) or when additional falls need to be created. For fuller details, please refer to the brochure "Design and installation guide – Podium Roof Decks / Parking Roof Decks".

4 Nophadrain Intensive Green Roof Systems

4.1 Roof with sufficient fall 1 in 80 to 50 °

a. Warm roof construction / roof construction without thermal insulation

Surface load*: 282 - 3,202 kg/m²

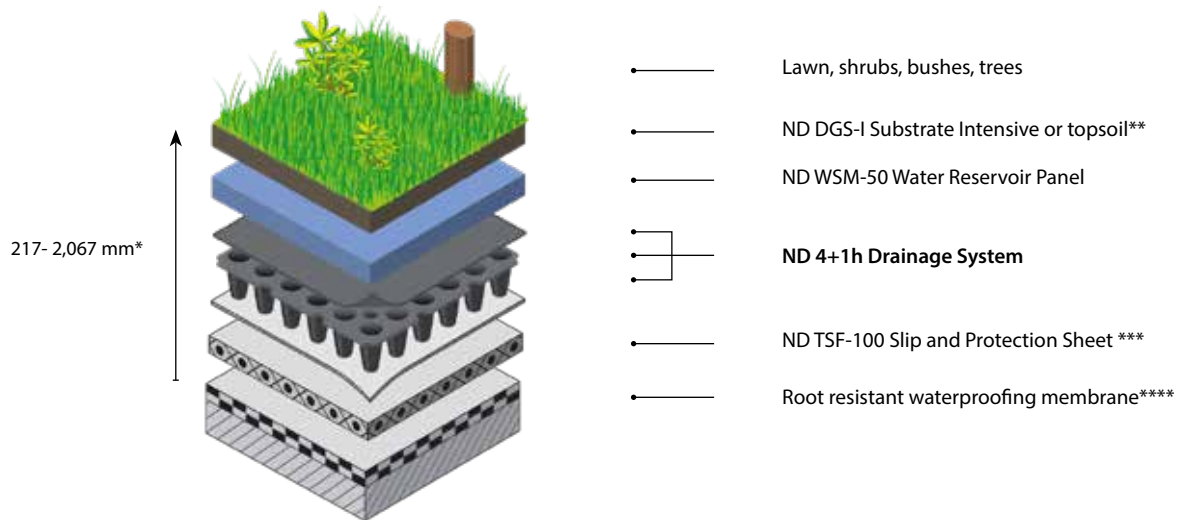

b. Inverted roof construction

Surface load*: 282 - 3,202 kg/m²

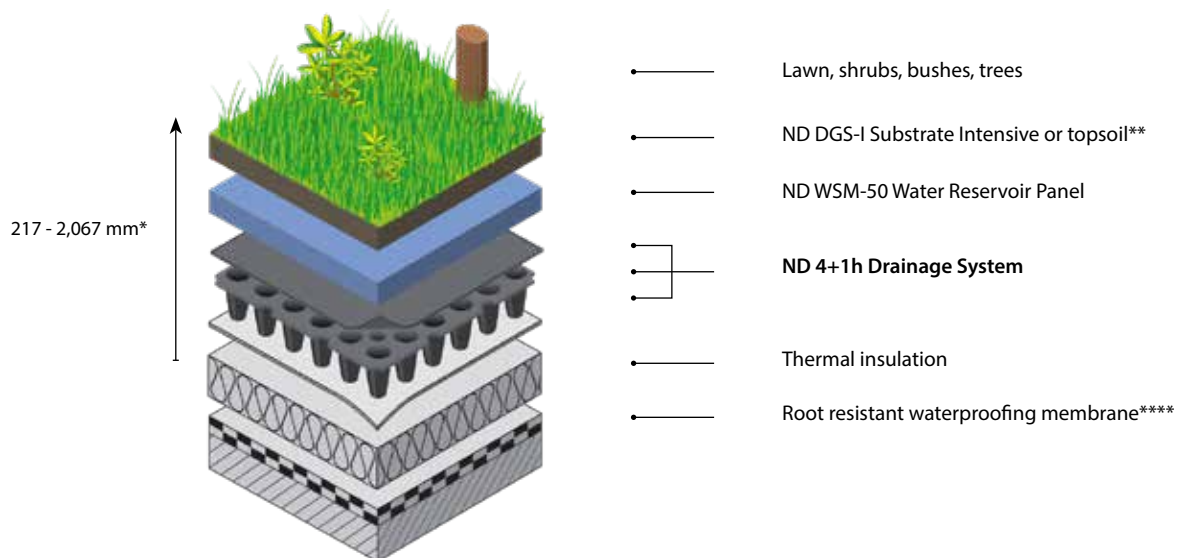

* Composition depth and surface load depend on the type of vegetation; the values mentioned are typical values

** At depths greater than 500 mm (350 mm with topsoil), a pure, mineral-based substrate should be installed beneath the substrate layer

*** Optional as extra protection of the waterproofing membrane

**** Optional ND WSB-80 Root Barrier

4.2 Roof with insufficient fall < 1 in 80

a. Warm roof construction / roof construction without thermal insulation

Surface load*: 285 - 3,205 kg/m²

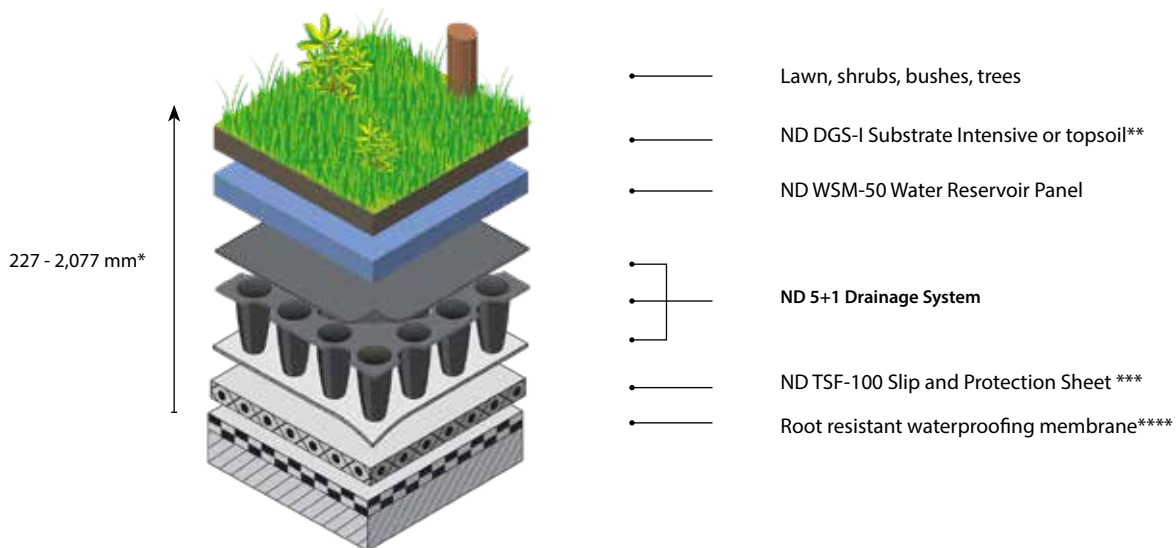

b. Inverted roof construction

Surface load*: 285 - 3,205 kg/m²

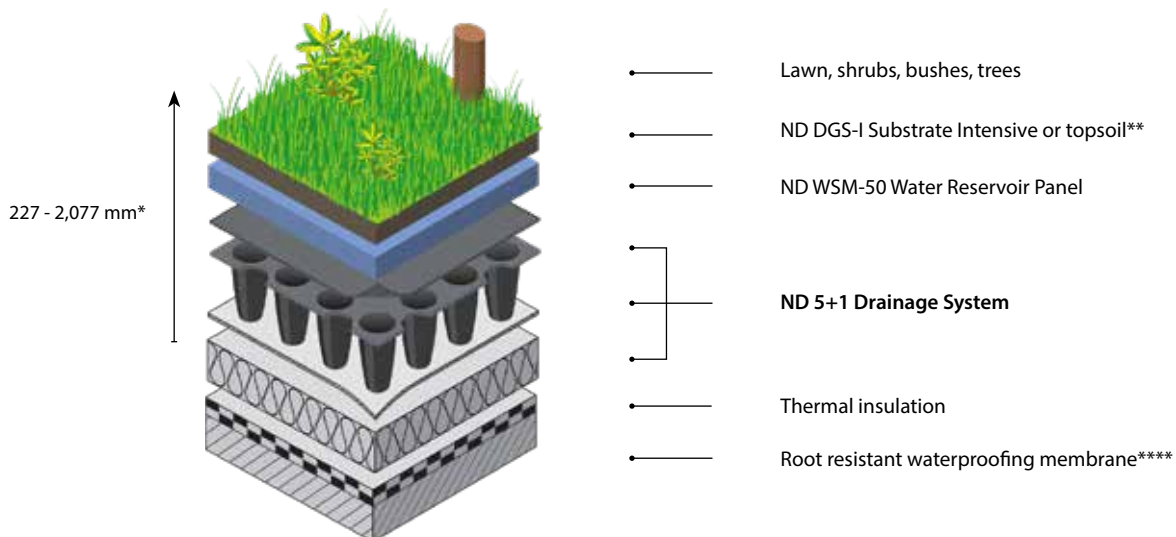

* Composition depth and surface load depend on the type of vegetation; the values mentioned are typical values

** At depths greater than 500 mm (350 mm with topsoil), a pure, mineral-based substrate should be installed beneath the substrate layer

*** Optional as extra protection of the waterproofing membrane

**** Optional ND WSB-80 Root Barrier

Composition of an intensive green roof

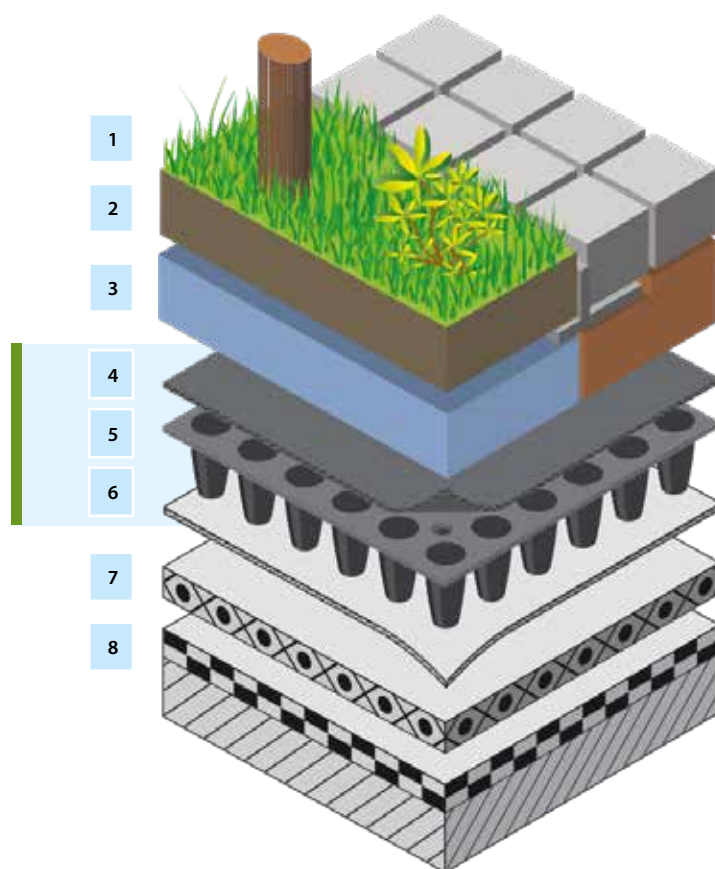

1	Vegetation layer	Intensive planting scheme: lawn, shrubs, bushes, trees
2	Substrate layer	ND DGS-I Substrate Intensive / topsoil*
3	Water reservoir layer	ND WSM-50 Water Reservoir Panel
4	Filter layer	ND 4+1h Drainage System
5	Drainage layer	
6	Separation and protection layer	
7	Protection layer	ND TSF-100 Slip and Protection Sheet**
8	Root barrier layer	Root resistant waterproofing membrane***

* At depths greater than 500 mm (350 mm with topsoil), a pure, mineral-based substrate should be installed beneath the substrate layer

** Optional as extra protection of the waterproofing membrane

*** Optional ND WSB-80 Root Barrier

This information is published by Nophadrain BV as a contribution to good practice in the application of green roofs in the UK. Whilst every care has been taken in its preparation, Nophadrain excludes any liability for errors, omissions or otherwise arising from the contents of this brochure. The reader must satisfy himself or herself as to the principles and practices described in this brochure in relation to any particular application and take appropriate, independent, professional advice.

©Nophadrain 02.2020 EN



Nophadrain BV

Visiting address
Mercuriusstraat 10
6468 ER Kerkrade
The Netherlands

Postal address
Postbus 3016
6460 HA Kerkrade
The Netherlands

 +31(0)45 535 50 30

 info@nophadrain.com

 www.nophadrain.com
